

REVISIONS			
DATE	NAME	NUMBER	
AUG. 1, 1989	HOWARD M. SCHOOR	14551	
SEP. 1, 1994	HOWARD M. SCHOOR	14551	

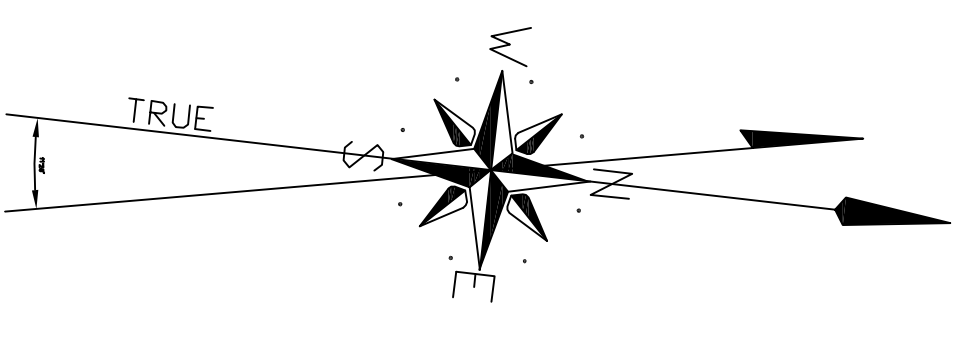
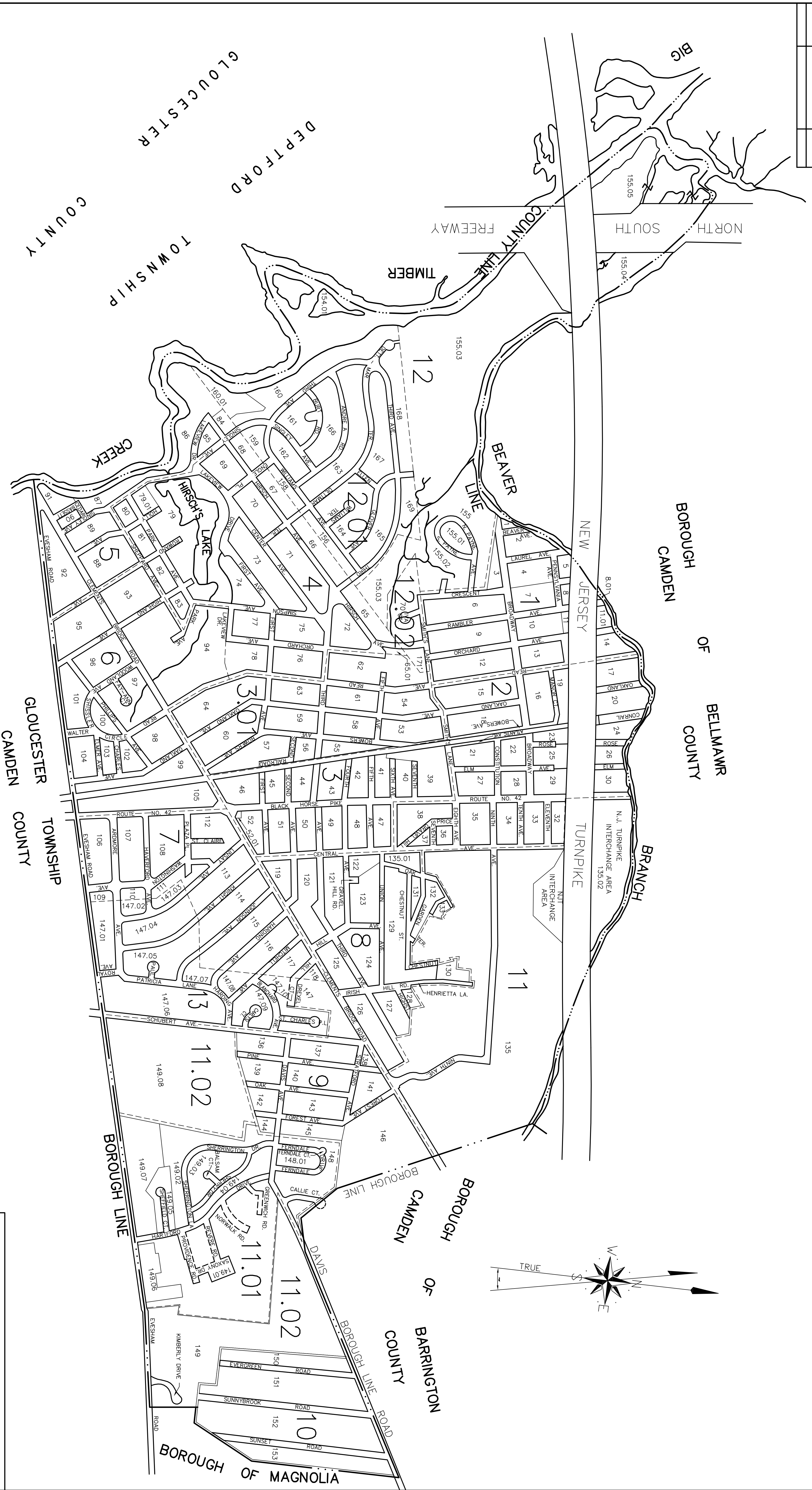

THIS TAX MAP SUPERSEDES A TAX MAP DATED OCTOBER, 1986 BY JOHN G. REUTER WHICH SUPERSEDED A TAX MAP DATED FEBRUARY 2, 1981

THE AREAS, BOUNDARIES, AND DIMENSIONS SHOWN ON THIS MAP ARE DERIVED FROM GROUND SURVEYS, AERIAL SURVEYS, AND RECORDED PLANS, MAPS, DEEDS, WILLS, AND ARE TO BE USED FOR ASSESSMENT PURPOSES ONLY.

I HEREBY CERTIFY THAT THIS MAP AND ANY REQUIRED SURVEYS HAS BEEN MADE UNDER MY IMMEDIATE SUPERVISION AND COMPLIES WITH THE LAWS OF THE STATE OF NEW JERSEY

HOWARD M. SCHOOR N.J. LICENSE #14551

**TAX MAP**  
**BOROUGH OF RUNNEMEDE**  
**CAMDEN COUNTY, NEW JERSEY**  
 SCALE: 1" = 500'  
 OCTOBER-1988  
**HOWARD M. SCHOOR P.E.-L.S.**  
**DREWES AND LOWE**  
 1200 LAUREL OAK RD.  
 VOORHEES N.J. 08043  
 TO SHOW CONDITIONS AS OF OCTOBER, 1994