

REVISIONS		
DATE	NAME	NUMBER
AUG.1.1998	HOWARD M. SCHOOR	14551
APR.1.1991	HOWARD M. SCHOOR	14551

DEPTFORD TOWNSHIP
GLOUCESTER COUNTY

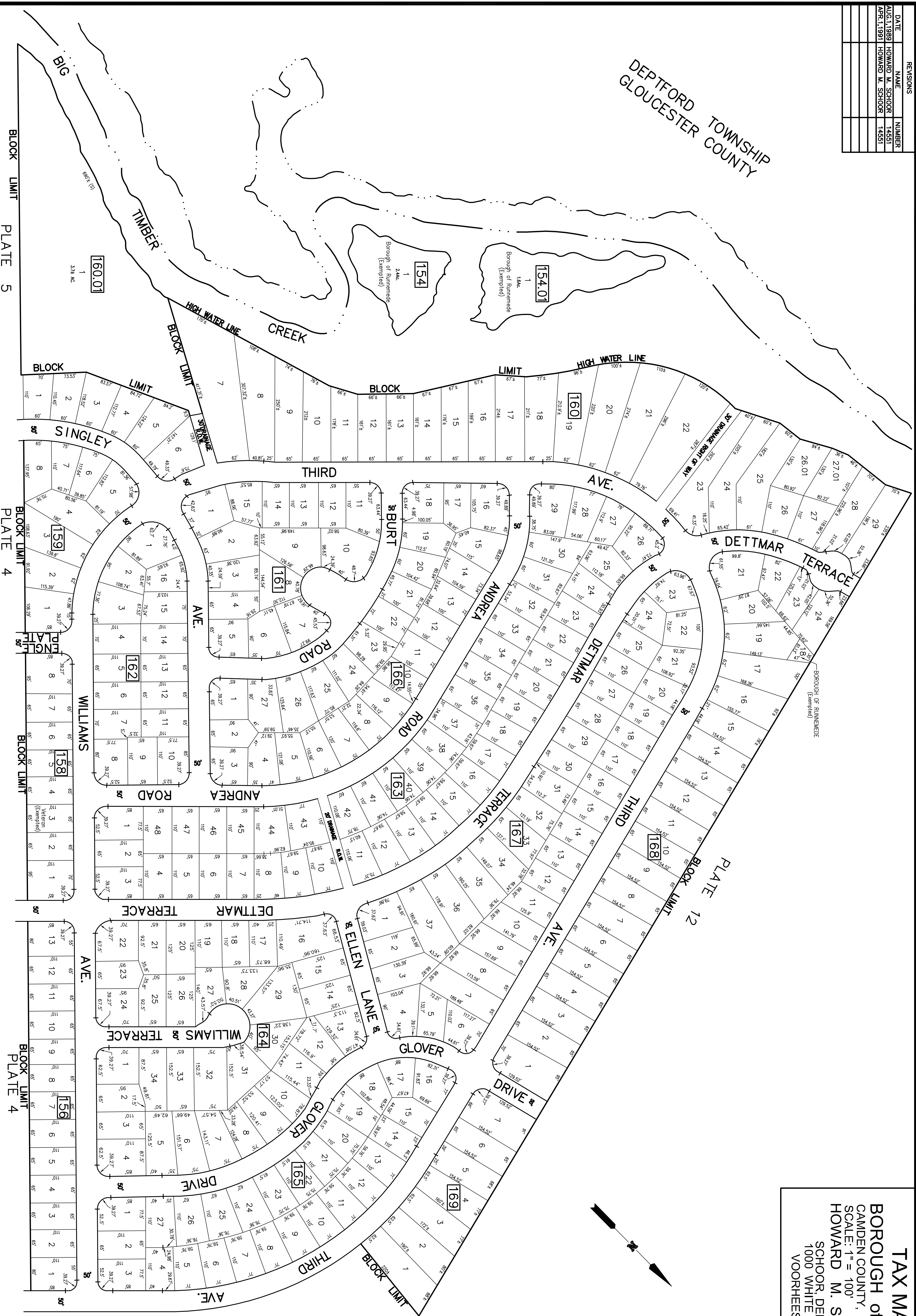

TAX MAP
BOROUGH of RUNNEMEDE
CAMDEN COUNTY,
NEW JERSEY
OCTOBER-1988
HOWARD M. SCHOOR P.E.-L.S.
SCHOOR, DEPALMA & LOWE
1000 WHITE HORSE ROAD
VOORHEES, N.J. 08043

PLATE 12